



Made in USA



## EmArc<sup>®</sup> SMR-75/LFL Metal Arc

The latest development in Emarc<sup>®</sup> technology, the new SMR-75/LFL, 75 watt lamp, has an optimized design that addresses illumination challenges in fluorescent microscopy systems and other unique scientific or industrial optical applications.

The SMR-75/LFL lamp is another masterfully engineered lamp from Ushio America, that combines the benefits of our unique Emarc lamp discharge technology with precisely crafted and manufactured parts resulting in a powerful and compact lighting solution.

EmArc lamps are a progressive step ahead in lighting technology, possessing features that offer advantages to an array of users for imaging, fiber optic and other important optical applications.

### FEATURES & BENEFITS

- Unique Long Focal Length Reflector Design Greatly Improves Optical Throughput Efficiency.
- 1.2 mm Arc Gap Size Enables Very Precise Optical Control and Well Defined Light Distribution Pattern.
- 'Plug and Play' Lamp Design Requires No Lamp to Lamp Adjustment or Alignment in Your Optical System Compared to Other Traditional Lamp Sources.
- Highly Durable and Precisely Machined Reflector Parts Ensure Lamp to Lamp Integrity, Alignment and Consistency in Your Equipment.
- Emarc DC, Metal-Arc Technology, Enables Operation on Simpler, Lower Cost DC Power Supplies Reducing OEM System Design Costs.
- Lower Power (Wattage) Reduces Thermal to Load to Sensitive Equipment, like Microscopes, or Sophisticated Optical Systems Simplifying Lamp House Design and Lowering Overall System Costs.
- Xenon-Like Correlated Color Temperature for Crisp, White, Bright Illumination.
- Excellent Field Uniformity and Intensity in Fluorescent Microscopy Applications, Featuring Outputs and Peak Intensities in Important Spectral Areas.

### APPLICATIONS

- Microscopy
- Medical and Industrial Fiber Optic Illumination
- Bio-Technology and Bio-Medical Optical Instrumentation

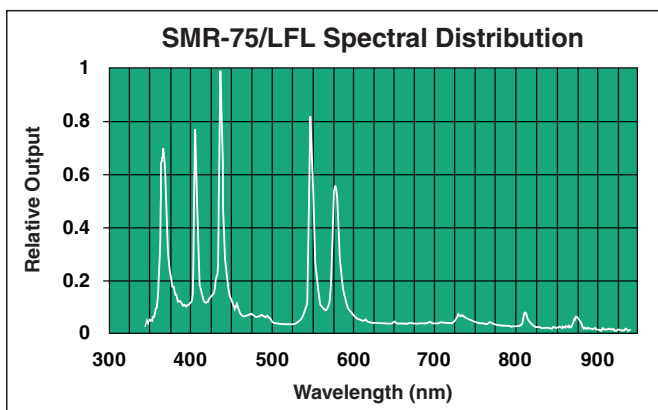

# SPECIFICATIONS

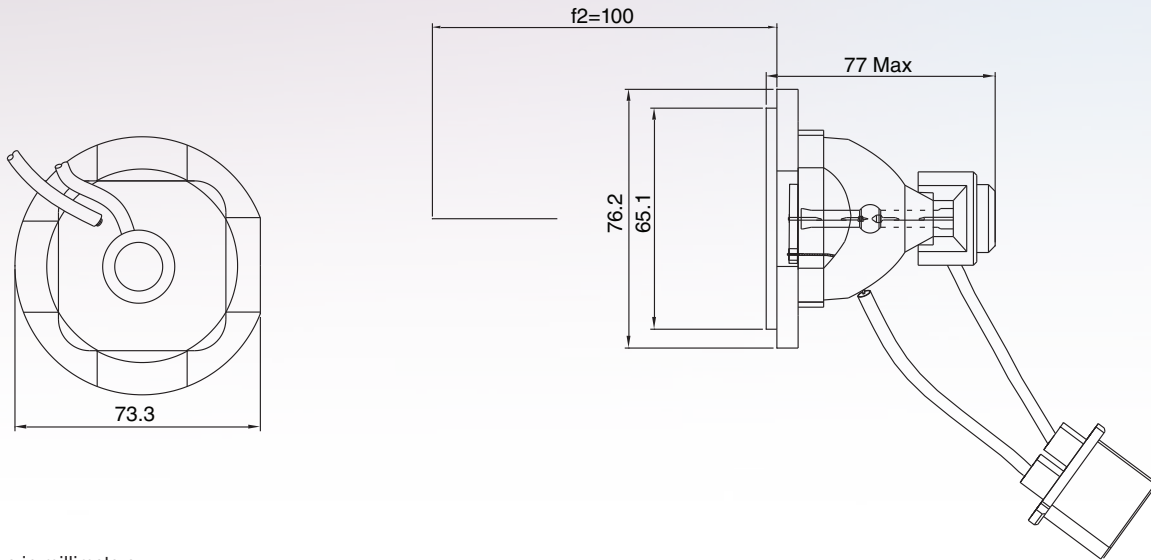

All dimensions are in millimeters.

Wattage Power Range (W)	Ordering Code	Lamp Description	Lamp Voltage (V)	Ignition Voltage	Minimum Voltage After Start Up	
50 - 75	5002312	SMR-75/LFL	55V DC (-8+12)	25kV (for Hot Re-ignition)	10 - 15V DC	
Lamp Current (A)	Maximum Allowable Starting Current	Arc Gap (mm)	Color Temp* (K)	Lumen Flux* (lm) nom	Average Rated Life** (h)	Typical Warm Up Time
1.33 nom.	2.3A	1.2	6800	700	600	90 sec. nom.

\* Output and Correlated Color Temperature as measured through a 4mm aperture at 100mm from the reflector rim. Actual values are dependent upon optical set-up.

Ballast must be certified by USHIO.

\*\* Life at 50% down in luminous flux or 50% failure to operate. (Dependent upon system and operating conditions).

## UBX-76 ELECTRONIC POWER SUPPLY

### SMARTARC™ SERIES

Operates EmArc DC lamps in power ranges between 50W-75W.



 contains mercury  
contient du mercure



Manage in Accord with Disposal Laws  
[www.lamprecycle.org](http://www.lamprecycle.org) 1-800-895-8842

 **CALIFORNIA PROPOSITION 65 WARNING:** These products can expose you to Mercury known to the state of California to cause birth defects or other reproductive harm. For more information, please go to: [www.p65warnings.ca.gov](http://www.p65warnings.ca.gov).

# USHIO