



PD-LD offers extended reach InGaAs PIN photodiodes whose design is intended for operation beyond the operating wavelength range of standard material. These extended reach photodiodes will operate from 1.0 to 2.6 microns, with their optimal performance found between 1.6 and 2.5 microns. These detectors have a 300um diameter active area allowing them to be coupled to optical fibers having core diameters from 3um to 200um.

Pigtailing

Devices can be pigtailed with any size optical fiber that is compatible with its active area size. Pigtails may range in core size from 3um to 100micron. One meter is the standard length, but any length or connector termination may be specified. Pigtails may be terminated

Receptacles

Standard ST, FC and SC housings are available in both panel and board mountable versions. These receptacles can be optimized for use with both single mode and multimode optical fibers.

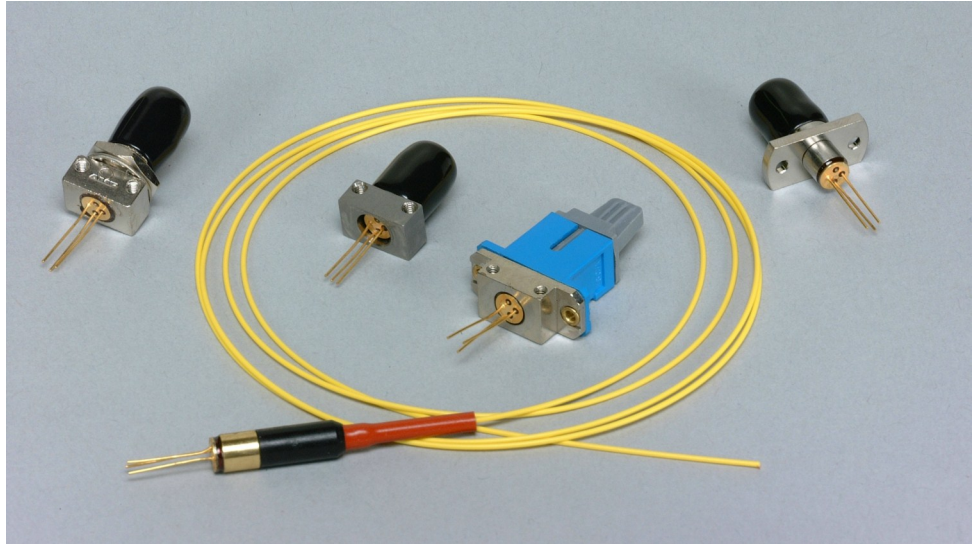

Features

- Low Noise
- High Sensitivity
- Multiple Packaging Options
- Hi Reliability
- Cut-Off Wavelength 2.6 microns
- Wide Bandwidth
- Compact Size
- Cost Effective

Applications

- Spectral Monitor
- Optical Measurement
- Interferometry
- Gas Analysis

PD-LD Part Number	Active Area (µm)	Responsivity (A/W) @		Capacitance @0V and 1MHz (pF)		Dark Current @0.5V (uA)		Cutoff Frequency @0V -3dB (MHz)		Shunt Resistance @10mV (kΩ)	
		Min.	Typ.	Typ.	Max	Typ.	Max	Min.	Typ.	Min.	Typ.
InGaAs (@ 0V bias, 1.7 to 2.3 microns, 25°C)											
PDINCH300FC21-T-0	300	1.0	1.3	50	100	0.4	4.0	20	50	20	100



Pinout

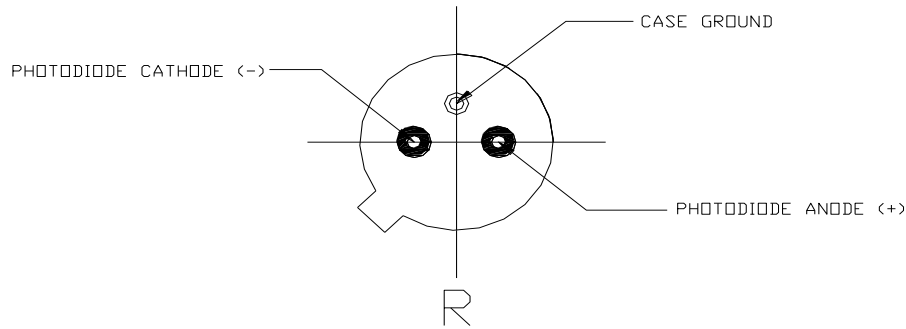

Pigtailed	Receptacle
P DXXKAAAFCCB-O-V-M	PDXXKAAACCCF-O-V

Device Type XX	Device Code K	Active Area AAA	Fiber Size F (µm)	Connector CC Pigtail Only	Receptacle CCC	Bracket B Pigtail Only	Orienta- tion O	Pigtail Length M
IN=InGaAs PIN	CH	300=300microns	1=9/125/900	FC=FC/PC	FC1=Panel Mount	A=None	T	10=10m
			2=50/125/900	FA=FC/APC	FC2=Board Mount	B=102-10112 Panel		03=3m
			3=62.5/125/900	SC=SC/PC	ST7=Low profile	C=102-10181 BdMt		01=1m
			4=100/140/900	SA=SC/APC	ST8=High profile	D=102-10198 BdMt		.5=0.5m
			9= customer supplied	ST=ST/PC	SM1=SMA Board Mount	W=Bracket Shipped Separately		.1=0.1m
			A=200/240/900		SC6= SC Board Mount	X=Customer Supplied		
			D=105/125/900					



FC Board Mount Receptacle

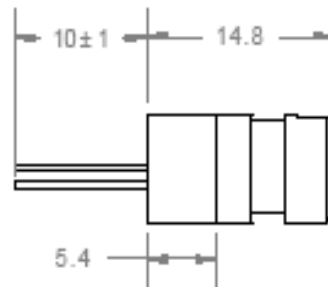
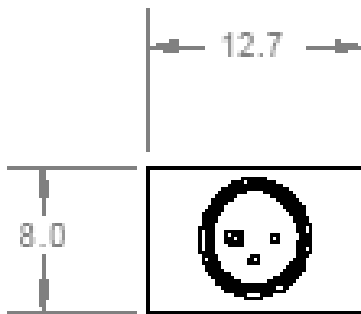
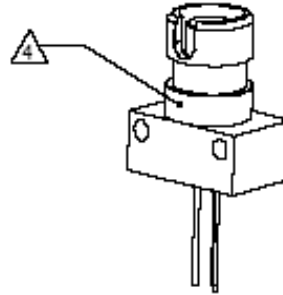
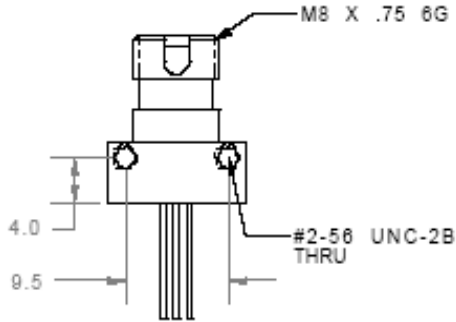



Parameter	Min	Max	Unit
Reverse Voltage	-	1.0	V
Optical Input Power	-	5	mW
Operating Case Temperature	-40	85	C
Storage Temperature	-40	85	C
Soldering Temperature (10 seconds)		250	C

▣ Spectral response

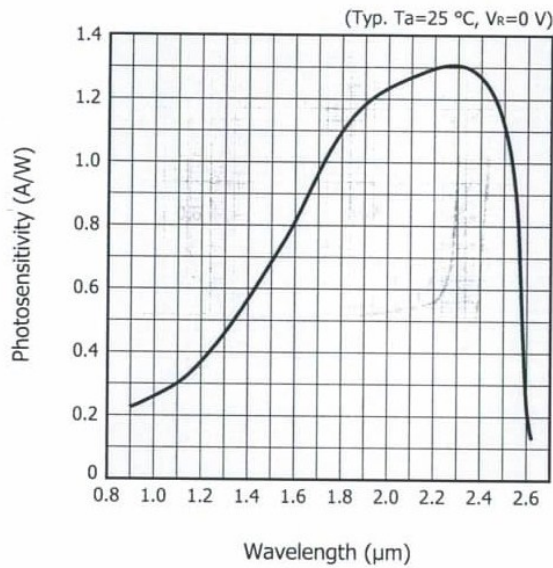

▣ Photosensitivity temperature characteristic

